

NEW 'NEW ROAD LAYOUT AHEAD' SIGN TO DIAG. 7014 ON EXISTING LC11.



NEW PRIORITY SIGN AND SUPPLEMENTARY PLATE TO DIAG. 811 AND 811.1 ON EXISTING LC14.



NEW 'NEW ROAD LAYOUT AHEAD' SIGN TO DIAG 7014 ON EXISTING LC18 (ABOVE EXISTING CYCLE SIGN)



PROPOSED PRIORITY GIVE WAY CROSSING POINT - FOR MORE DETAILS SEE INSET A & INSET B

NEW PRIORITY SIGN AND SUPPLEMENTARY PLATE TO DIAG. 615 AND 615.1 ON EXISTING LC15.



INSTALL NEW 'SLOW' MARKING TO DIAG 1024. (1.6m HEIGHT).

INSET A - 1:100 (KERB WORKS)

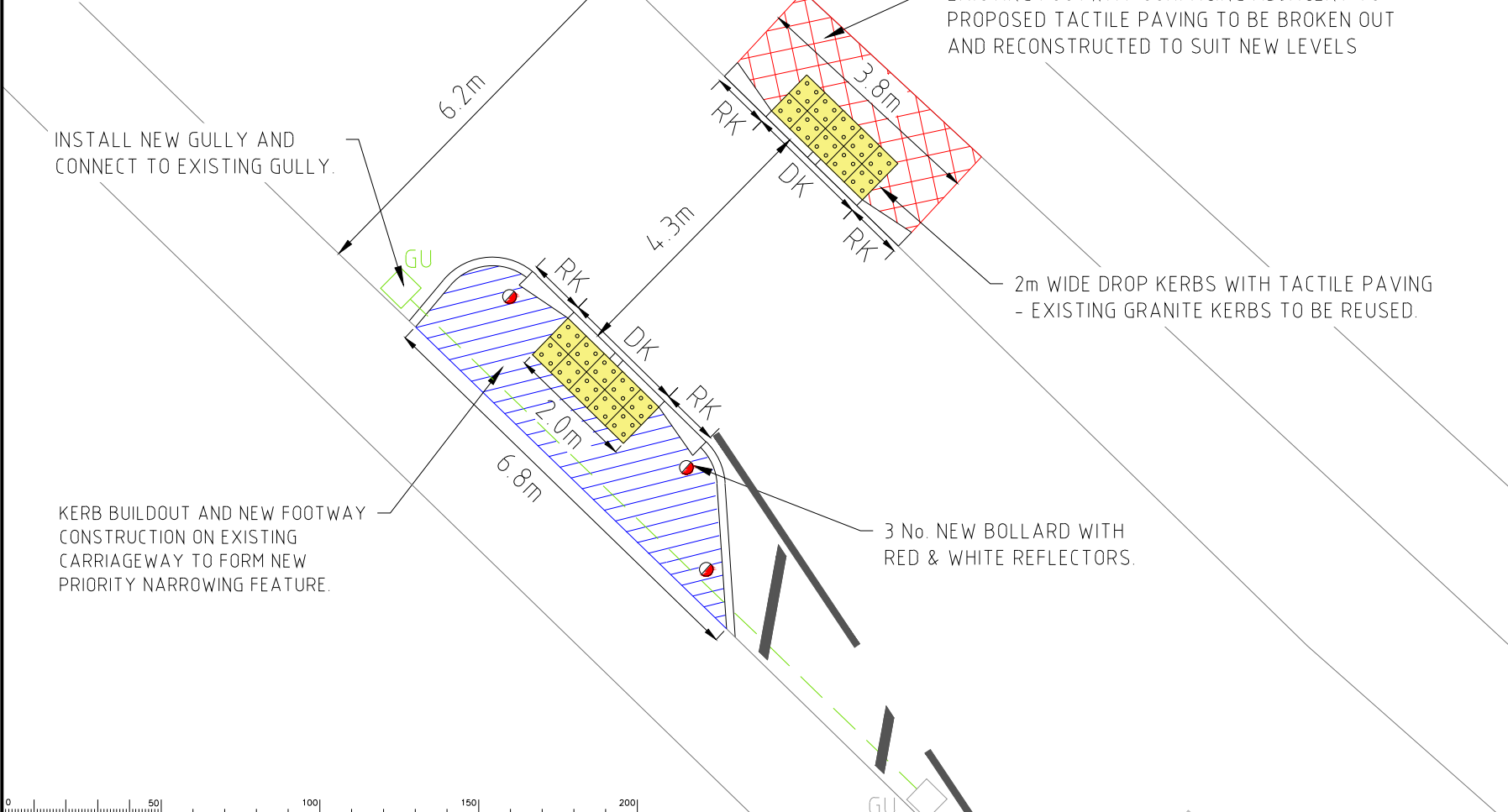

INSET B - 1:250 (ROAD MARKINGS)

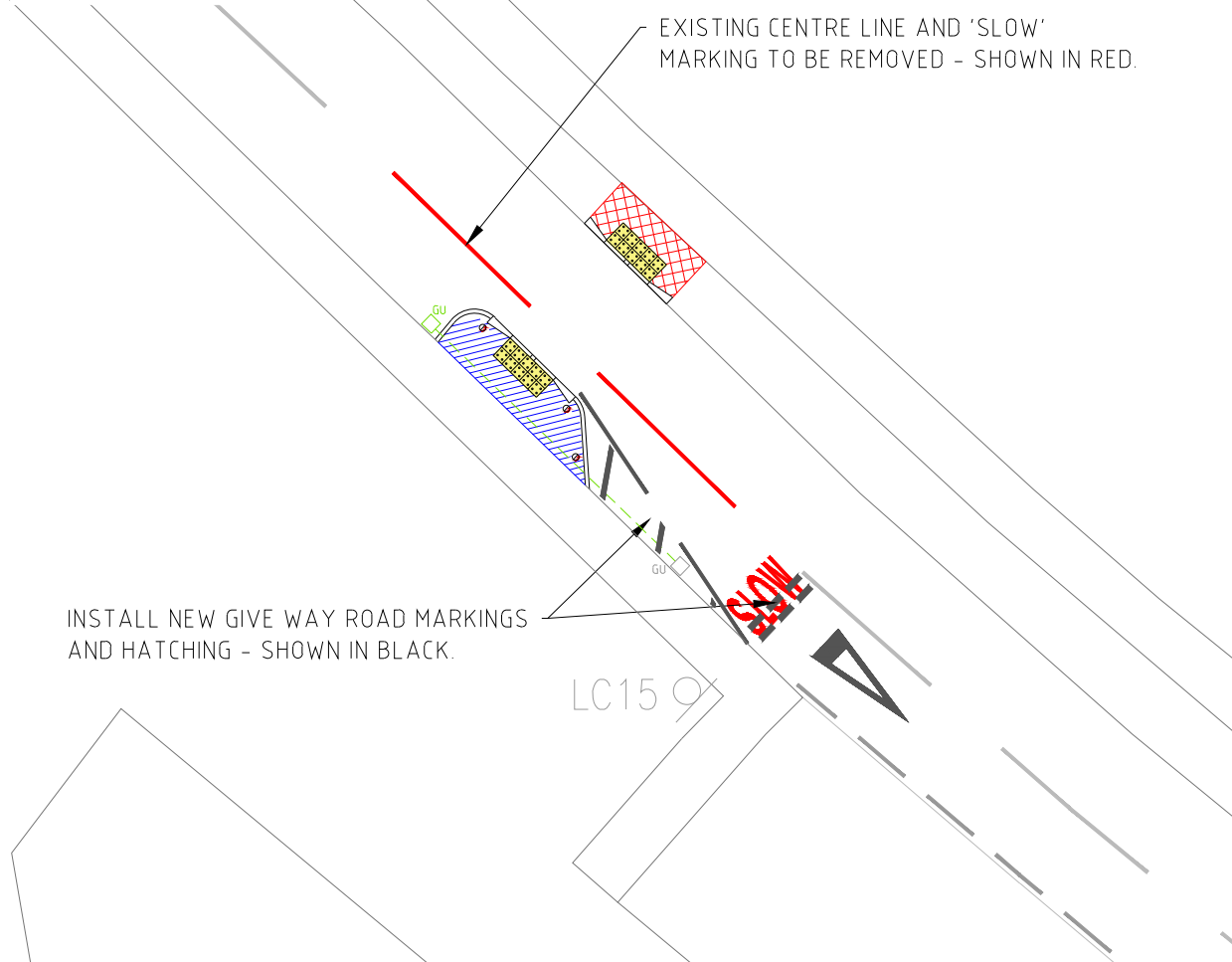

Page 83

Notes

Rev.	Description	Drwn	Sig.	Date	Chkd	Sig.	Date	Appr	Sig.	Date

Drawn by	Sig.	Date	Checked by	Sig.	Date	Approved by	Sig.	Date
CHB	CHB	JAN 19	JD	JD	JAN 19			

North Point

Based upon the Ordnance Survey mapping with the permission of the Controller of Her Majesty's Stationery Office. © Crown copyright. Unauthorised reproduction infringes Crown copyright and may lead to prosecution or civil proceedings. Surrey County Council LA 076872 2002.

Project: LALEHAM VILLAGE FEASIBILITY SHEPPERTON ROAD

Drawing: CROSSING OPTION 2 PRIORITY GIVE WAY

Project No. PC0939

Contract Sheet No. PC0939\_02

Drawing No. -

Classification: PRESENTATION

This page is intentionally left blank